

Canon

meap
POWERED BY I



MEAP[®] SOLUTIONS PORTFOLIO

Next-Generation Technology for Higher Business Productivity

Ever since Canon introduced its Multifunctional Embedded Application Platform (MEAP) several years ago, many software developers have been delivering unique applications that address a variety of needs. MEAP is an application platform that allows developers to create software applications that can reside on those Canon imageRUNNER® multifunction devices enabled with MEAP.

The objective of the MEAP Solutions Portfolio brochure is to showcase developed MEAP applications. Since development activity is ongoing, it's recommended that you visit our Alliances section of the Canon U.S.A., Inc. web site at www.usa.canon.com to see the latest developments and applications.

MEAP has helped set Canon apart from the competition by enabling our MFP devices to deliver personalized applications for end-users. This, in turn, has paid dividends to our customers by improving their workflows while helping Canon become a recognized leader in digital office solutions. Canon is committed to helping customers succeed in today's challenging business environment. With MEAP, any type of business can evolve into a more integrated and productive enterprise.

MEAP APPLICATION TYPES

The MEAP Solutions Portfolio brochure is organized into three chapters, representing the sources of MEAP development activity:



CUSTOM MEAP APPLICATIONS

Customers take advantage of MEAP to customize their imageRUNNER devices to meet their specific workflow needs. For example, clients who want to scan documents from their imageRUNNER device to their company database directory can create an application that results in a special “button” located on the imageRUNNER device that triggers this unique process. Customers can even create the application themselves—provided they have the development expertise in-house—or Canon U.S.A. can develop the application on the customer's behalf.

Customer-specific MEAP applications generally fall into four basic types:

A. Authorized Send

- Forces users to authenticate themselves first before accessing the imageRUNNER device's document distribution capabilities while allowing all users to access basic copy features.

B. Scan-to-Database

- Allows clients to scan documents from the imageRUNNER device to their company's unique database.

C. Advanced Authentication

- This is for companies that have authentication requirements above and beyond the standard authentication features included with the imageRUNNER device.

D. Kiosk

- Allows a customer to customize the panel of the imageRUNNER device LCD for “Pay for Copy or Fax” purposes.



INDEPENDENT SOFTWARE VENDOR MEAP APPLICATIONS

Independent Software Vendors (ISV) utilize the MEAP SDK (Software Development Kit) to create applications that integrate their software solutions with the imageRUNNER product line. For example, cost recovery vendors that employ a terminal to connect to an imageRUNNER device to capture the requisite data to record in their cost recovery solution can use MEAP and the imageRUNNER device panel to replace the terminal. MEAP allows ISVs to design the application such that the user interface and much of the functionality can reside directly on the imageRUNNER device itself, thereby eliminating the need for any additional hardware. As part of their overall software solution, ISVs typically market these types of applications, though in some cases Canon U.S.A., Inc. may resell the offering.



CANON BRANDED MEAP APPLICATIONS

Canon also makes use of the MEAP SDK platform to develop applications that are commercially available. Many of these provide a deep integration between Canon's imageWARE™ branded software applications and the imageRUNNER devices.



Table of Contents



CUSTOM MEAP APPLICATIONS

Authorized Send	2
Scan-to-Database	4
Advanced Authentication	6
GBCblue—COPYblue	8



INDEPENDENT SOFTWARE VENDOR MEAP APPLICATIONS

eCopy™ ShareScan® OP	10
Ribstone® EM1	12
Captaris RightFax® Integration for MEAP	14
Codehost®: imageRUNNER Smart Card Authentication	16
Pharos® iMFP for Canon	18
Equitrac® Embedded for Canon	20
nQueue® Embedded Brand: Integrated Cost Recovery for Canon	22



CANON BRANDED MEAP APPLICATIONS

imageWARE Document Manager Client for MEAP	24
imageWARE Accounting Manager for MEAP	26
Virtual Mailbox	28





Custom MEAP Applications

AUTHORIZED SEND

OVERVIEW

Authorized Send is a MEAP application customized for a client's unique environment that requires users to authenticate themselves to have access to Scan-to-E-mail and Scan-to-Folder features.

Users do not have to authenticate in order to access the basic copy features.

This application is capable of many features, including authentication against Microsoft® Domain, Address Book, Configurable Network Shares, and Enhanced Scan Settings, that allows the user to configure the resolution, color mode, image mode, brightness, and paper size.

Customized MEAP applications are ready made solutions that can be modified for specific customer environments with minimal development effort. Please contact your Canon Sales Representative if you are interested in customizing a MEAP application for your particular environment.

1. Authenticate the user.

2. Select Scan-to-E-Mail or Scan-to-Network folder.

3. Scan-to-E-Mail prompt screen.

The Custom MEAP Application solution screen shots are only examples for illustration purposes. The final look can vary depending on the customization.

SOLUTION SCENARIO

Compliance regulations dictate that companies have internal controls and audit trails in place to guard against the misappropriation of confidential and sensitive company information. The IT Manager of a company realizes that all employees can use the send function of the imageRUNNER device to transmit sensitive financial reports without any record of that activity. As such, he would like to require his users to authenticate themselves against the Active Directory® server prior to using the imageRUNNER device send function. He can achieve this by customizing Canon's Authorized Send MEAP application. This helps ensure that the devices are protected and have complete audit trails to help them from being misused. This helps the IT Manager secure the imageRUNNER devices while still allowing users to access the basic copy, print, and mailbox functions so that their general office workflows are not disrupted.

CUSTOMIZATION EXAMPLES

Authorized Send is built on the Canon MEAP platform and, therefore, can be customized to meet your requirements. Some sample customizations include:

- Adding your company logo to the user interface
- Restricting the functionality by allowing "Scan-to-Self" only or removing "Scan-to-Folder" features
- Adding additional file formats (i.e., JPEG, text searchable PDF, etc.)
- Authenticating against Novell® eDirectory

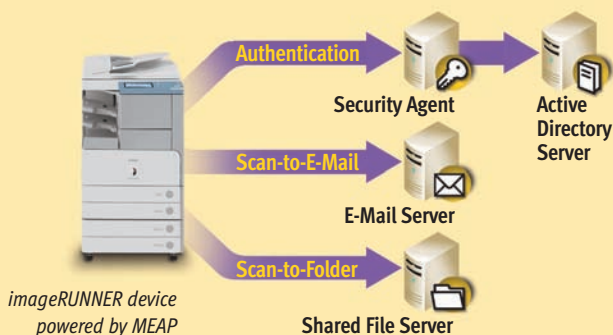

BENEFITS

- Protects your confidential information by preventing unauthorized users from accessing Scan-to-E-mail and Scan-to-Folder features.
- Increases security by ensuring that e-mails sent from imageRUNNER devices can be associated back to an authorized user.
- Streamlines workflow by allowing basic copy features to be easily used but require user authentication for Scan-to-E-mail and Scan-to-Folder features.

TARGET MARKET

The solution is best suited for organizations that want to allow only authorized users to have access to Scan-to-E-mail and Scan-to-Folder features; however, all users can access device copy features without having to authenticate.



Custom MEAP Applications

SCAN-TO-DATABASE

▷ OVERVIEW

Scan-to-Database is a customized MEAP application that allows customers to scan documents from the imageRUNNER device into their company's database. Customized index information can be entered directly at the imageRUNNER device's user interface. Document images and index information can be sent to a company's database by sending the document image and index information into a network folder. Here it can be automatically imported into a database, or the document image and index information can be sent via e-mail and imported into the database.

Customized MEAP applications are ready made solutions that can be modified for specific customer environments with minimal development effort. Please contact your Canon Sales Representative if you are interested in customizing a MEAP application for your particular environment.



Login ID:

Password:

Log In

1. Authenticate the user.

Customer:

Invoice #:

PO #:

Back

Please press (Ctrl) key to scan.

2. Scan to company database with index information.

The Custom MEAP Application solution screen shots are only examples for illustration purposes. The final look can vary depending on the customization.

SOLUTION SCENARIO

A law firm stores large volumes of document images in a document management system designed for the legal industry. The method currently used to upload document images into the firm's database is cumbersome. A user must first scan the document image to a client's PC, log-in to the document management system through a Web browser, enter the index information, then browse and upload the document image.

The law firm can automate this process and allow its users to scan and index documents directly from its imageRUNNER device and send them into the document management system with Canon's Scan-to-Database workflow, which increases workflow efficiency.

BENEFITS

- Automates the document capture workflow by allowing users to scan, index, and send document images from an imageRUNNER device to a document database, thus improving workflow efficiency.
- Eliminates the manual process of scanning and uploading documents into document databases, which saves time.
- Leverages the database and imageRUNNER device investment by making it easier for users to store document images.

CUSTOMIZATION EXAMPLES

Scan-to-Database is built on the Canon MEAP platform and, therefore, can be customized to meet your requirements. Some sample customizations include:

- Adding your company logo to the user interface
- Customizing the application to connect to different databases or workflow engines
- Customizing the index fields to capture pertinent information
- Supporting additional file formats (i.e., JPEG, text searchable PDF, etc.)

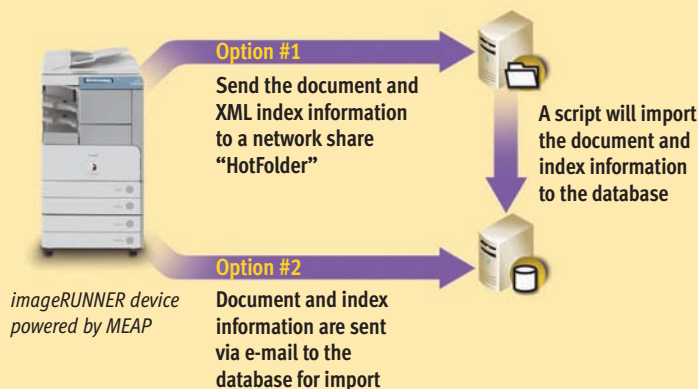

TARGET MARKET

Any organization looking for a fast and efficient method to scan hard copy documents into their company database.



Custom MEAP Applications

ADVANCED AUTHENTICATION

▷ OVERVIEW

Advanced Authentication is a MEAP application that can be customized for a client's unique environment that requires users to authenticate before using any of the functions of an imageRUNNER device. Advanced Authentication enhances an enterprise's need for securing access to their imageRUNNER device. Advanced Authentication helps protect confidential information by preventing unauthorized users from accessing the device, which helps in securing the environment and strengthening internal controls. Advanced Authentication could also allow an IT Manager to grant access to the imageRUNNER device from a central location which helps further secure the device. For tracking device usage, Advanced Authentication can be used together with imageWARE Accounting Manager to collect, analyze, and track device usage throughout an organization.

Customized MEAP applications are ready-made solutions that can be modified for specific customer environments with minimal development effort. Please contact your Canon Sales Representative if you are interested in customizing a MEAP application for your particular environment.

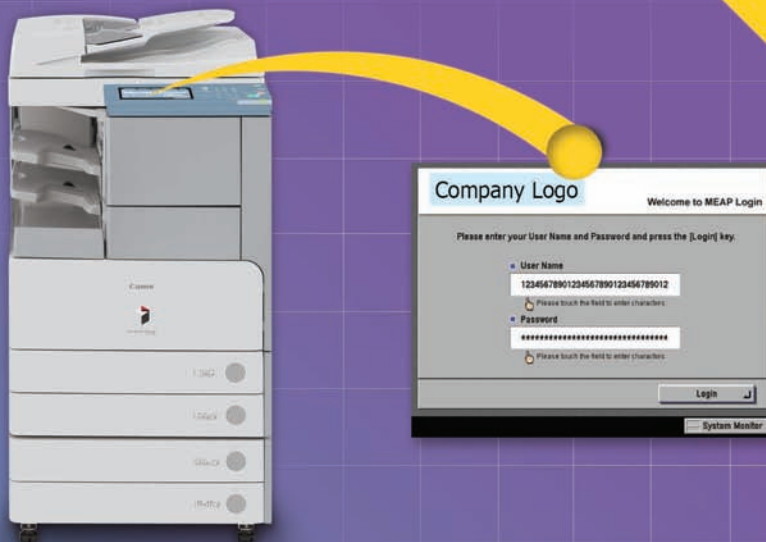

The Custom MEAP Application solution screen shots are only examples for illustration purposes. The final look can vary depending on the customization.

SOLUTION SCENARIO

St. Mary's hospital must protect patient information to comply with HIPAA Privacy and Security rules. In order to secure patient information, the hospital would like to make all employees log-in to imageRUNNER devices before copying, scanning, e-mailing, or faxing documents. With Advanced Authentication, the hospital can add information security, and employees can use their same Novell® network ID and password. With the optional imageWARE Accounting Manager application, they can also track user activity and capture audit trails.

BENEFITS

- Protects your confidential information by preventing unauthorized users from accessing the imageRUNNER device.
- Manages who is authorized to use the imageRUNNER device from a central location.
- Creates usage reports and charge-back usage of the device to each user or department with the optional imageWARE Accounting Manager software.

CUSTOMIZATION EXAMPLES

Advanced Authentication is built on the Canon MEAP platform and, therefore, can be customized to meet your requirements.

Some sample customizations include:

- Adding your company logo
- Authenticating against different directory servers

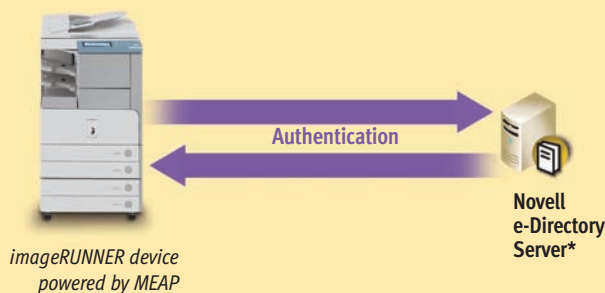

**Advanced Authentication can be customized to support other directory servers.*

Statements made in this document are the opinions of Canon U.S.A. None of these statements should be construed as legal advice, as Canon U.S.A. does not provide legal counsel or compliance consultancy, including without limitation, Sarbanes-Oxley, HIPAA, GLBA, Check 21 or the USA Patriot Act. Each customer must have its own qualified counsel determine the advisability of a particular solution as it relates to regulatory and statutory compliance.

TARGET MARKET

This solution is best suited for companies that use Novell® eDirectory™ as their authentication mechanism and would like to use it to require their users to authenticate themselves prior to accessing the imageRUNNER devices.



Custom MEAP Applications

GBCblue—COPYblue

OVERVIEW

COPYblue is a MEAP application that essentially converts an imageRUNNER device into a self-operated business amenity that hotels use to provide their guests with walk-up copy and fax service. Hotels guests can swipe their credit card or hotel-provided debit card to unlock the device and allow the guests to make copies and send faxes. The imageRUNNER device interface is completely customized, making it very easy to use. Upon completion, users obtain a printout of the receipt summarizing their activities and charges.

The COPYblue application makes use of the imageRUNNER device's remote status and diagnostics capabilities by sending automatic notifications to GBCblue, the servicing dealer, to ensure the system is up and running. As a result, hotels can place the COPYblue in an easily accessible area, without any need for additional staff.

COPYblue was co-developed by GBCblue and Canon utilizing the MEAP SDK.

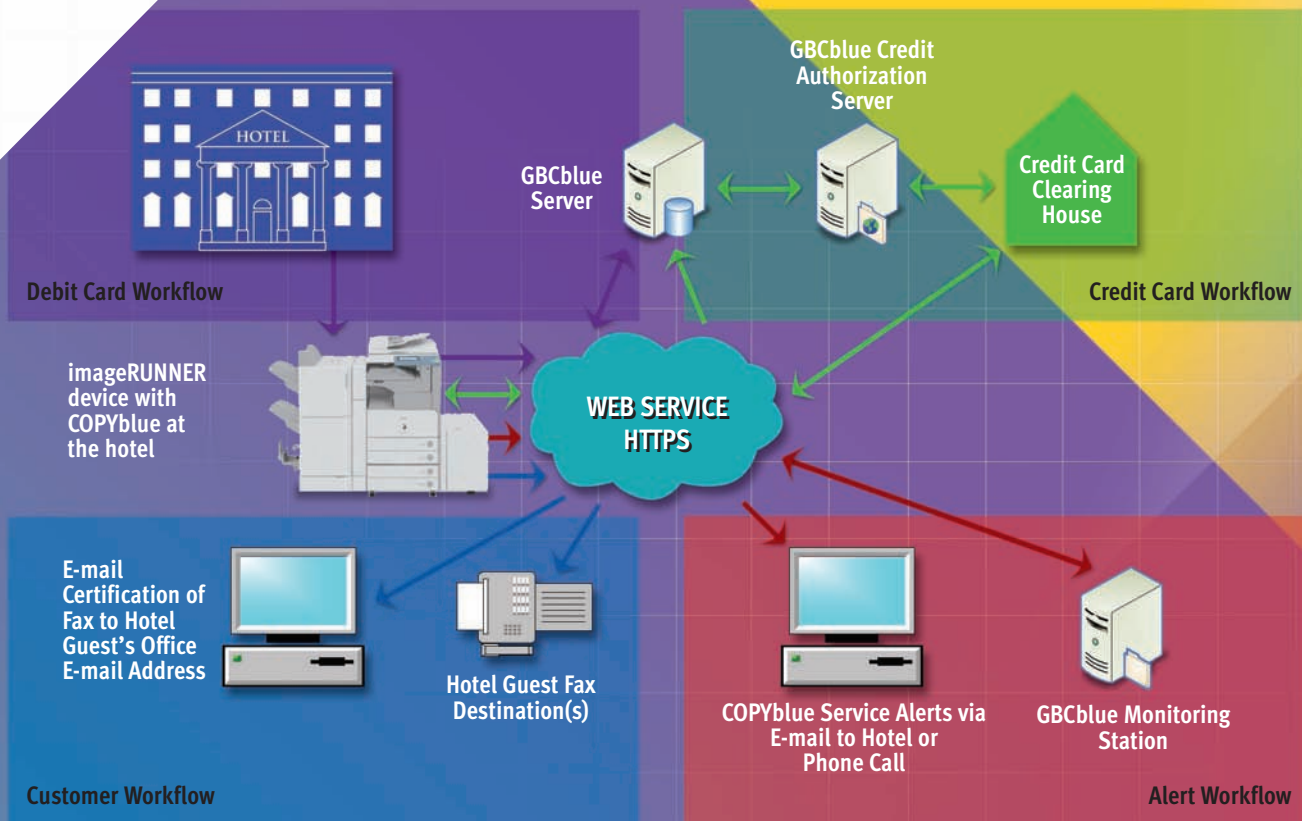

SOLUTION SCENARIO

COPY CAPABILITY

A financial planning company is hosting an off-site seminar at a local hotel. The presenter would like to hand out copies of his presentation, but he didn't prepare the handouts in advance. In order to lure the financial company to the hotel site, the hotel manager provided the attendees with a prepaid debit card that entitled them to \$10 worth of free copies on the COPYblue. The presenter takes the debit card and makes his copies.

FAX CAPABILITY

A hotel guest checks in after signing up a new client. She's eager to get the client established in the company system at headquarters and needs to fax the newly completed credit card application. She walks up to the COPYblue and swipes her credit card. She faxes the credit application to headquarters and receives the receipt.

REMOTE MONITORING CAPABILITY

A hotel just hosted a series of meetings as part of its busy season. The COPYblue was very popular among the guests and they made many copies of the session's handouts. As a result, the toner was running low. Fortunately, the COPYblue system automatically sent a "Low Toner" message to the GBCblue offices. GBCblue identified the hotel and dispatched a dealer to visit the hotel and replenish the toner, prior to actually running out.

SOLUTION COMPONENTS

GBCblue sells COPYblue as a turnkey solution directly to its hotel clients. Hotels only need to have a Canon IR Device enabled with MEAP technology, Internet access, and a business relationship with GBCblue.

BENEFITS

For Hotel

- Allows hotels to provide their guests with around the clock access to copy and fax service, without the need for additional staffing.
- Provides hotels with an opportunity to earn additional revenue while also providing a much needed amenity.
- Provides remote diagnostic tools, which means that hotels don't have to invest additional staffing and resources to ensure that the device is up and running.
- Allows some hotels to qualify for a higher rating by being able to provide a business center.
- Allows hotels to meet the needs of the lucrative convention and business meeting events.

For Guests

- Convenient, around-the-clock access to copy and fax capabilities.
- A simple and easy-to-use interface means that guests can quickly make copies and faxes.
- Fax confirmations can be forwarded to the user's e-mail account.
- COPYblue's checkout page means that the guest has a real-time confirmation of his or her activity that can also serve as a receipt for reimbursement.
- COPYblue accepts VISA®, MasterCard®, American Express®, and DISCOVER® credit cards.
- COPYblue accepts prepaid debit cards, which can be purchased at the hotel.

TARGET MARKET

COPYblue is designed for hotel and hospitality venues to provide a self-service credit- and debit-card-enabled system to provide their guests and clients with around-the-clock access to copy and fax capabilities.

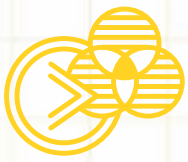

Independent Software Vendor MEAP Applications

eCOPY™ SHARESCAN® OP

▷ OVERVIEW

The addition of eCopy to the high-speed scanning capability of an imageRUNNER device enables virtually any office worker to securely incorporate paper-based information directly into any business software application. Office workers quickly adopt and use eCopy because it's so easy. Scanning and routing the document is as simple as the push of a button, with no training required.

Businesses that want to speed the processing, increase the security, and reduce the cost of business workflows achieve this through the seamless and easy connectivity of eCopy ShareScan with Desktop and Connector software. eCopy provides tightly integrated, "real-time" connections to more software applications than any other MFP scanning and routing software available. Businesses that utilize both Canon imageRUNNER devices and DR-Series Scanners also benefit from a common (eCopy) user interface that enables office workers to use the same procedure for scanning and routing documents, regardless of device, which helps to assure compliance with company guidelines.

eCopy helps maximize the ease of administration and minimize technical support calls by enabling IT staff to administer the system from a central location, avoiding the need to visit individual MFPs. eCopy's leverage of network security protocols and real time authentication provides the assurance that security minded organizations require. Administrators can easily configure it to provide an audit trail that includes what documents were sent where, by who, and when.

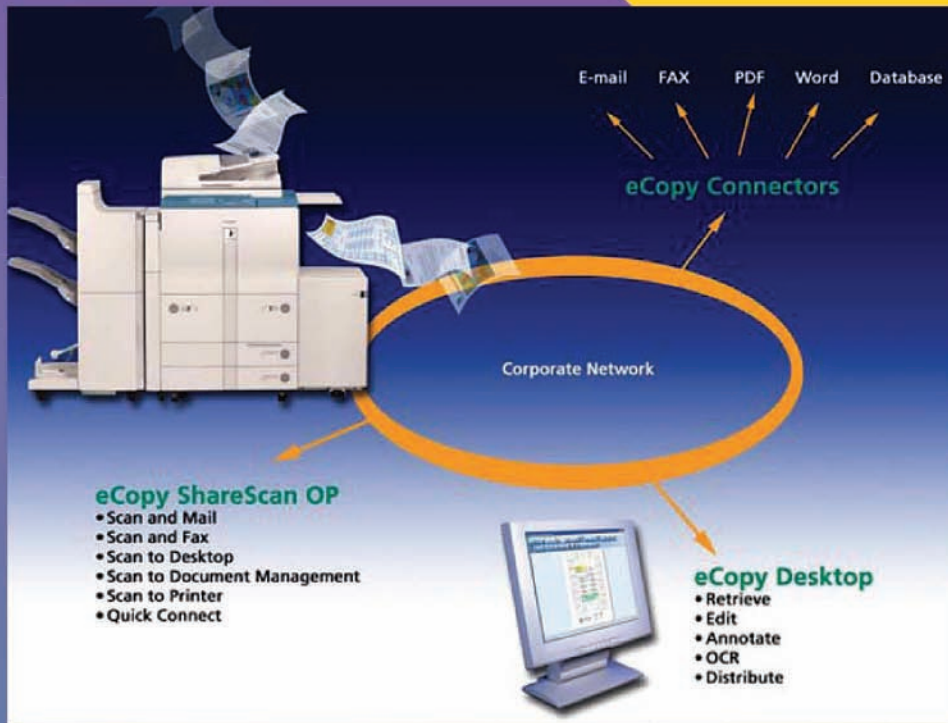



SOLUTION SCENARIO

A mortgage provider was able to cut the time needed to process lengthy loan applications by 30 percent by using a combination of eCopy™ software and Canon imageRUNNER multifunction printers (MFPs). More than 90 percent of this company's nearly \$2 billion in loans last year were applied for using paper applications. Even small mortgage loans involved 100 to 125 pages of paper.

With eCopy's Desktop and ShareScan OP software, the mortgage provider's employees use the imageRUNNER device to scan loan documents quickly and securely into PDF documents for electronic archiving. Once the paper document is transformed into PDF, multiple users can view and highlight sections of the PDF or add annotations. It provided a more productive way for employees to collaborate on documents, which resulted in dramatically increased loan throughput. The combined solution allows them to:

- Digitize documents and transform them into universally-readable PDF files in 30 to 60 seconds.
- Combine Word documents and other electronic files instantly with scanned documents into a single PDF file.
- Annotate, highlight, and sign PDF documents without the need for additional software.
- Encrypt sensitive PDF files so that they could be e-mailed securely to and from branch and central offices without risk.

▶ SOLUTION COMPONENTS

- Canon imageRUNNER device enabled with MEAP technology
- eCopy ShareScan OP
- eCopy Desktop

BENEFITS

- Eliminates the timely task of repeating scans with eCopy's scan preview feature
- Manages eCopy-enabled devices from a central location with eCopy's real-time native integration saving an IT Administrator valuable time
- Provides a user interface that mimics the characteristics of the application meaning little user training is required
- Offers a unique user experience based on the user's credentials giving the user immediate access to the appropriate files and folders right at the copier
- Ensures a consistent level of security and aides in compliance by maintaining a complete audit trail by enabling IT Administrators to use the security features such as SSL, encryption, and user authentication

TARGET MARKET

Companies in legal, financial, healthcare, insurance, government, construction, or services that need to integrate paper into their workflow.



Independent Software Vendor MEAP Applications

RIBSTONE EM1

OVERVIEW

Ribstone's EM1 is an easy-to-use, Bates Stamping application for the instant creation of paginated photocopies for corporate legal departments and law firms. Operators are able to copy files with just one pass of an original document from an imageRUNNER device, while simultaneously applying a Bates Number endorsement and additional text for added clarity or instruction. Eliminating the need for the traditional time-consuming and manual "copy-label-copy" process, EM1 replaces label printers, hand stamps, and lost time due to uneven placements of labels, raised labels, or rescanning. With EM1, legal workers enjoy the quickest Bates Stamping solution available in the market—it's easy-to-use, robust, and embedded within their imageRUNNER device.



- Set a Prefix of up to 50 Characters
- Start Bates Number
- Set a Suffix
- Select Finishing Options
- Add Two Programmable Lines of Text, each up to 50 characters

- Select Placement of Each Endorsement

- Create Instant Copy Sets with Bates Stamp and Text Endorsement

- Output



1

2

3

4



SOLUTION SCENARIO

Convenient Bates Stamping—a law firm or legal service bureau requires an easy-to-use Bates Stamping solution to replace the less efficient processes of “copy-label-copy” or use of a Bates hand stamp. These processes of using labels or stamps are prone to error and are time-consuming, expensive, and inaccurate. Furthermore, these solutions can require two passes of original documents.

Ribstone EM1 enables the imageRUNNER device operator to walk up to the device and simply apply a Bates number, complete with alpha prefix, start number, and suffix. The operator can also add two customized text messages that are typically required in the legal industry, such as “Confidential” or “For Attorney’s Eyes Only.” Ribstone EM1 also offers the flexibility to place the text anywhere around the page with twelve available zones. Users can also select from multiple fonts, sizes, and styles, while using all the finishing features available on the imageRUNNER device. This functionality greatly improves upon efficiency and can replace the existing copy-label-copy production process.

▶ SOLUTION COMPONENTS

Ribstone EM1 includes a MEAP .jar file installed on the imageRUNNER device and software that’s loaded onto a computer with an Intel® Celeron® D Processor (2.53GHz).

- The computer does not need to be placed in direct proximity to the Canon imageRUNNER device and can reside anywhere on a company network.

BENEFITS

- Easy-to-use, Canon and Ribstone touch-screen interface requires minimal training.
- Bates number instantly while copying in a single pass.
- Bates number with several placement and font options.
- Customize text messages with multiple placement and font options.
- Reduce the need for the traditional process of “copy-label-copy” (uneven placement, raised labels, or time and money lost to rescanning).
- Capture billing information and export to cost recovery applications, such as Equitrac and nQueue.
- Allows for the full range of finishing options offered by the imageRUNNER device, such as halftone printing for better resolution, staples, auto-detect page size, and hole punch.

TARGET MARKET

Law firms, facilities management companies, corporate legal departments, legal print-for-pay vendors, government, and regulatory agencies are all experiencing the key benefits of using Ribstone EM1 for Bates numbering and pagination on Canon imageRUNNER devices.

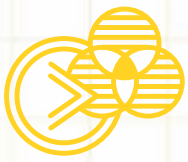

Independent Software Vendor MEAP Applications

CAPTARIS RightFAX INTEGRATION FOR MEAP

OVERVIEW

Canon U.S.A., Inc. and Captaris have partnered to embed RightFax network faxing and electronic document delivery software within Canon imageRUNNER devices, utilizing Canon's innovative MEAP technology. Captaris Rightfax Integration for MEAP is an embedded application that allows for bi-directional communication between the imageRUNNER device and RightFax. It's comprised of the RightFax MFP Module version 3.0 and the MEAP platform to integrate the device with the latest version of RightFax. The resulting integration gives users easy access to the extended delivery and notification options of RightFax Enterprise or business servers directly from Canon imageRUNNER devices.



1. Log-in to RightFax Server.
2. Access Phone Book, Cover Sheet, and Billing Copies Based on Log-in Credentials.
3. Send Documents via Standard Fax, Certified Delivery, Encrypted, or Other Delivery Options.
4. Receive Printed Delivery Notification.

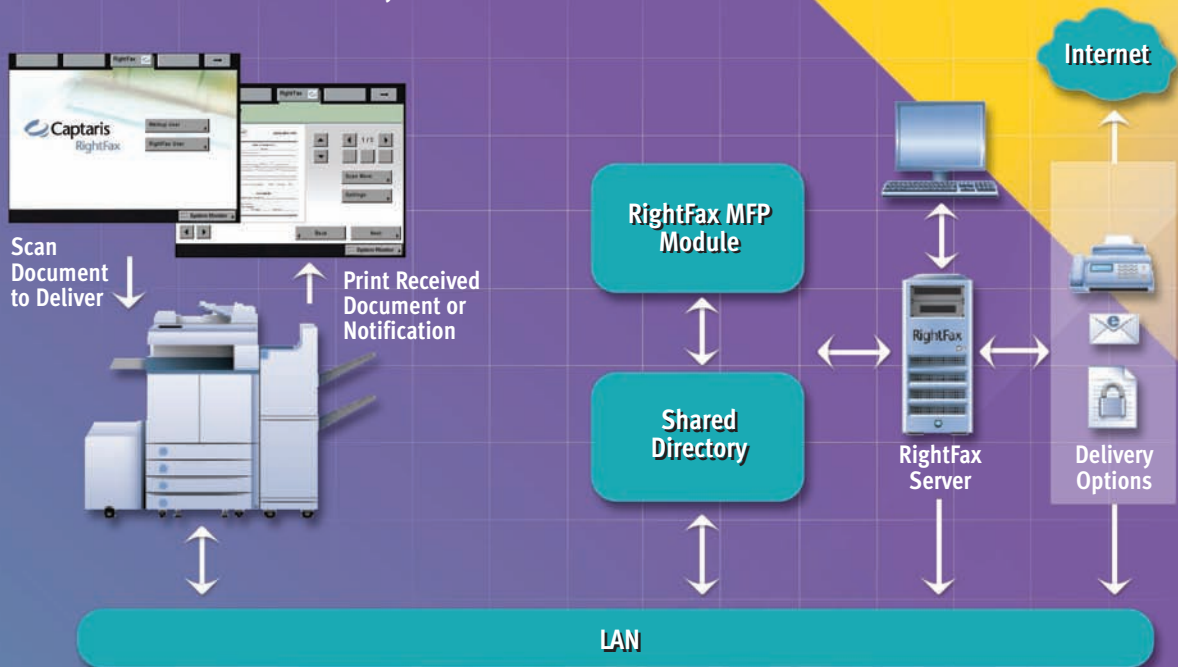

BENEFITS

Cost control through consolidation

- Captaris RightFax Integration for MEAP can support many MFPs. This enables organizations to consolidate resources and reduce costs by eliminating multiple stand-alone fax machines, modems, phone lines, and supplies.

Increase productivity and efficiency

- Users can print, scan, copy, and fax from one consolidated device. This translates into sizable improvements in productivity and more timely communications with customers and suppliers.

Enhanced security and compliance

- RightFax provides tamper-resistant document delivery, as well as options such as certified or encrypted e-mail delivery to safeguard privacy and support compliance (e.g., SOX and HIPAA).

Extend infrastructure investments

- RightFax is a simple and effective way to optimize existing IT infrastructure. It extends the value of imageRUNNER devices and integrates with e-mail, document management, ERP, workflow, and other applications to make a more efficient, connected work environment.

Simplified deployment and management

- Deploying and managing multiple systems can be time- and labor-intensive. RightFax integrates with imageRUNNER devices and simplifies administrative functions by centralizing document development, duplication, and delivery functions on an integrated networked solution.

SOLUTION SCENARIO

The mortgage industry provides a number of examples of how Captaris RightFax and Canon can work together to provide enhanced productivity. Because documents need to be transferred quickly, often with signatures or other handwritten notes, an onramp to network fax capabilities from imageRUNNER devices is extremely useful.

Mortgage processors or agents are able to walk up to an imageRUNNER device and use their credentials to log-in and access the same RightFax account they use from their desktop. In addition to core faxing capabilities, such as scheduling delivery, sending documents securely, and adding cover page notes, the RightFax integration to Canon devices allows dynamic two-way communication with the RightFax server. Staff members can use their own phone books, quickly check their inbox to see if a fax has arrived, or check details about an earlier transmission. Once documents are sent, users receive notifications and can view history logs because RightFax captures all vital information.

By providing RightFax functionality within imageRUNNER devices, organizations can efficiently and securely manage documents in a consolidated environment that supports compliance and reduces costs.

SOLUTION COMPONENTS

- Captaris RightFax Integration for MEAP is required per RightFax Server with an active license per each Canon MFP device and is available exclusively from Canon and its resellers.
- RightFax MFP Module 3.0 with Canon Extension (that installs on a RightFax Server)
- Captaris MEAP application
- Canon imageRUNNER devices enabled with MEAP technology

Note: RightFax Business or Enterprise Server 9.3 and above available from Captaris resellers. RightFax Enterprise Suite is required for encrypted and certified delivery options available from Captaris resellers. RightFax MEAP Client is available from Canon Authorized Dealers.

TARGET MARKET

Target Markets

- Small- and Mid-size Market
- Corporate and Enterprise

Industries

- Finance/Banking
- Healthcare
- Insurance
- Legal
- Business
- Government/Public/Education
- Building/Logistics/Manufacturing/Transports/Wholesale



Independent Software Vendor MEAP Applications

CODEHOST: imageRUNNER SMART CARD AUTHENTICATION

OVERVIEW

Security, accountability, and automation are the focus of many organizations implementing Smart Card solutions. Canon is leading the industry in supporting this technology trend by offering Smart Card and PIN authentication on its MEAP enabled imageRUNNER devices.

Canon's imageRUNNER Smart Card Authentication solution extends a company's existing security infrastructure to include the networked imageRUNNER device. The solution provides a Login Service and Authentication Server and relies on the Canon MEAP platform to restrict access to the imageRUNNER device to holders of authorized Smart Card IDs, requiring any walk-up user to first authenticate before having access to the device. The solution allows the flow of information to be controlled within an organization helping to ensure compliance with governmental information security and traceability regulations such as HIPAA and Sarbanes-Oxley.



Codehost Inc.
THE SOFTWARE ENHANCED SMART HARDWARE

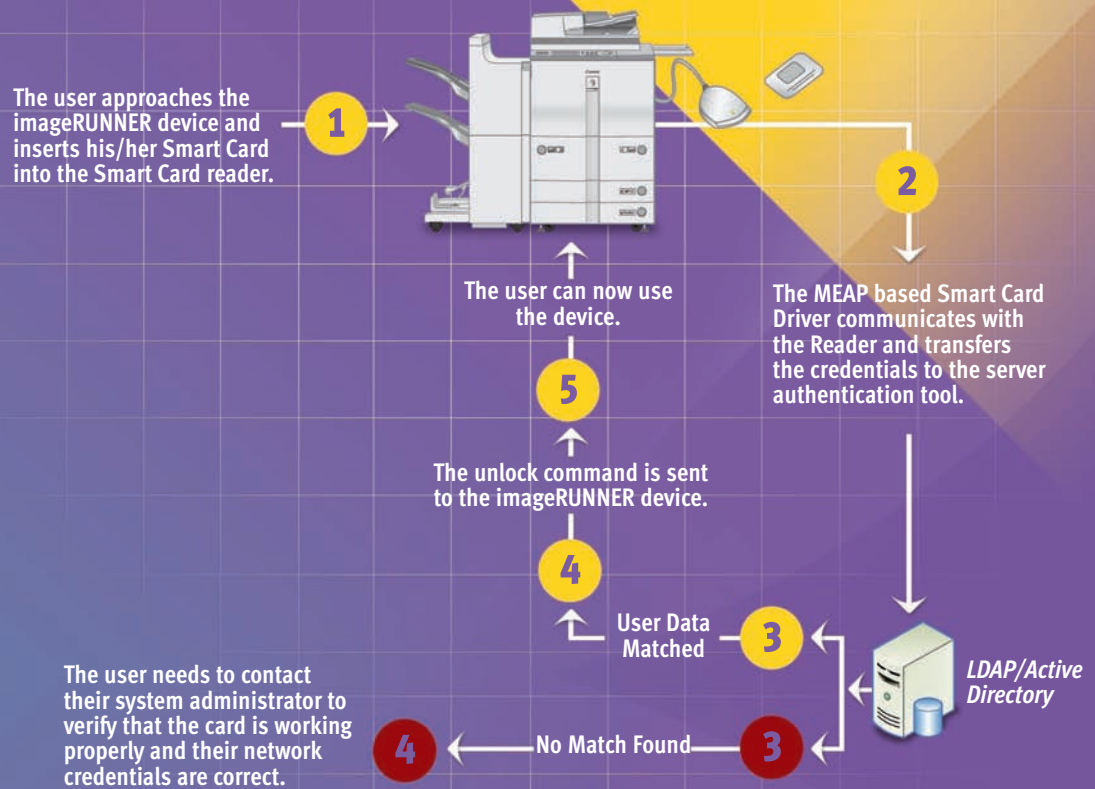

SOLUTION SCENARIO

A manufacturing company requires its research and development engineers to authenticate themselves with their company-issued ID card in order to access network devices. They are required to authenticate themselves at networked devices by swiping their ID cards and entering their pin number to help comply with internal policies and procedures. As a connected multifunction device, the imageRUNNER system falls into that requirement. Using the imageRUNNER Smart Card Authentication application, the manufacturing company can be assured that its research and development engineers cannot access the network imageRUNNER devices without their company-issued ID. This helps them meet their internal policies and procedures regarding networked devices.

SOLUTION COMPONENTS

Smart Card Reader

- Contact Smart Card supporting Sun's Javacard 2.2.1 or higher*
- Axalto Reflex v3, SCM SCR 3310, SCM SCR 3311 USB*
- Supports common standards, such as ISO 7816 Class A and AB smart cards, and major Smart Card protocols (T=0/T=1)
- CCID Compliant
- EMV Level 1 and PC/SC certification
- Supports card speeds up to 344Kbps

Authentication/Verification Server

- Operates as a Linux daemon or NT Service
- Conducts user credential verification against an LDAP directory

- Communicates with other independent components over network using TCP/IP
- Provides user log-in capabilities for the log-in system

Administrative Tool

- Bundled with Verification Server
- Allows the server to be configured and administered from both Windows and Linux environments
 - Server settings update
 - Log-in service update
 - LDAP and Active Directory Integration and Configuration
 - Host Lists
 - MFP Connections
 - Device Settings
 - APDU Token Configuration

* Canon's solution supports these stated cards and readers. Canon does not provide the readers or cards as part of the solution. Statements made in this document are the opinions of Canon U.S.A. None of these statements should be construed as legal advice, as Canon U.S.A. does not provide legal counsel or compliance consultancy, including without limitation, Sarbanes-Oxley, HIPAA, GLBA, Check 21 or the USA Patriot Act. Each customer must have its own qualified counsel determine the advisability of a particular solution as it relates to regulatory and statutory compliance.

BENEFITS

- Provides strong authentication and secure access to improve control of the flow of information
- Integrates with most Smart Card authentication solutions
- Enforces positive identification and tracking of users for greater accountability
- Helps ensure compliance with governmental regulations such as HIPAA and Sarbanes-Oxley
- Provides non-repudiation due to the combination of physical and electronic proof of individual involvement

TARGET MARKET

Financial and Public Sectors are target industries, but Smart Card utilization is horizontal across all industries.

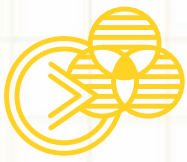

Independent Software Vendor MEAP Applications

PHAROS iMFP FOR CANON

OVERVIEW

Canon U.S.A., Inc. and Pharos Systems have partnered to place accounting and ID Card Authentication software directly inside Canon's Multifunctional Embedded Application Platform (MEAP). The power of Pharos Uniprint® and Off-the-Glass® software creates a new class of integrated Multifunction Printers (iMFPs), that provide fingertip access to powerful Pharos software solutions, including Pay-for-Print&Copy, User-based Job Accounting, Departmental Chargeback, and Secure Print Release and color control functionality. It's now easier than ever for users to access the services they need, and for businesses and higher education institutions of all sizes to rein in their out-of-control spending on printing and copying.

The Pharos iMFP for Canon tracks prints, copies, and scans directly from the Canon imageRUNNER device full-color LCD control panel of the MEAP iMFP. Users simply walk up and swipe/touch their ID card and the iMFP authenticates the user and tracks every page of every print, copy, and scan job. The costs are then charged back to an individual user's account or a departmental budget center. Real-time gateways are provided with the leading online transaction systems and a variety of back-office servers from Blackboard, CBORD, Diebold, and General Meters. Authentication gateways are provided for Active Directory, LDAP, Kerberos, and NDS. There's also a powerful and intuitive export wizard that enables customized data export files to be created and imported into most centralized billing and accounting systems.

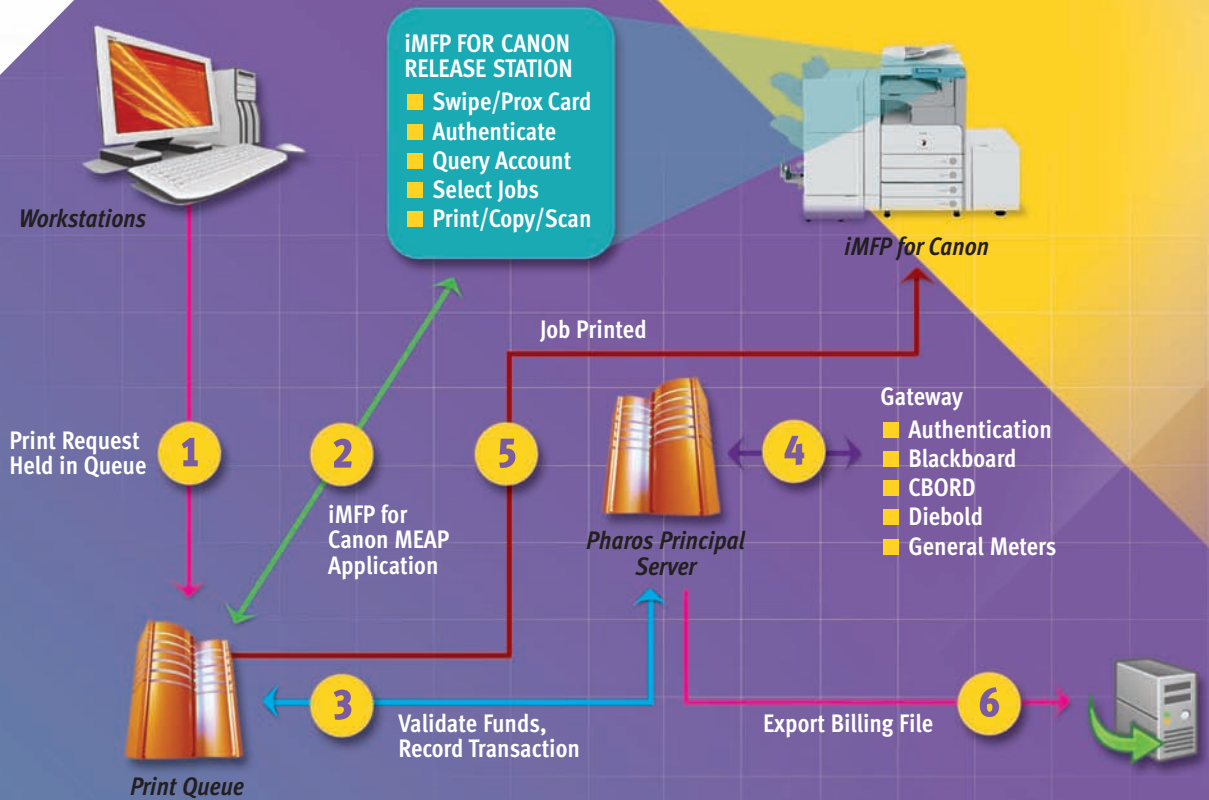

SOLUTION SCENARIO

HIGHER EDUCATION

The iMFP for Canon provides a solution for college campuses to track printing and copy costs for both student and department printing. Students can utilize their campus card to make copies or send print jobs (using Pharos Systems' mobile printing technology) to Canon devices located elsewhere on campus (such as libraries, administration building, student labs, etc.). Faculty can also utilize the iMFP for Canon to charge their print and copy costs back to select department codes, budget centers, grant codes, or to a personal purse, making users accountable for their charges and providing higher education institutions the ability to bill the appropriate source.

GENERAL OFFICE

Pay-for-print accounting is now easier and more secure than ever before. The iMFP for Canon provides a secure device that only authorized employees can use. By requiring employees to authenticate themselves, all print and copy costs can be charged back to select departments. Users are accountable for their charges and businesses can bill the appropriate source. And with Pharos Systems' mobile printing technology, users can print their documents from their laptops or desktops, and then pick up their print jobs at the iMFP that's most convenient for them. This iMFP can reside in their office, in a conference room down the hall, or even in an adjacent building. Once users arrive at the iMFP, the Secure Print Release feature ensures that users' jobs are only released from the device when the user is physically present to pick them up.

SOLUTION COMPONENTS

- iMFP for Canon MEAP software
- Canon imageRUNNER device enabled with MEAP technology
- Pharos Uniprint server
- Pharos Off-the-Glass software (for tracking copies)
- Magnetic Swipe Card Reader or Proximity Card Reader

BENEFITS

- Single User Interface – a large, easy-to-use, color LCD, touch-screen panel provides a single operator interface for User Authentication, Pay-for-Print&Copy, Secure Print Release, Color Control, and Departmental Chargeback.
- Integrated ID Card devices — Magnetic Swipe and Proximity card readers can be plugged directly into the imageRUNNER USB port to enable fast, easy authentication and user-based job accounting.
- Easy Enterprise Integration — integrates easily into your system by connecting to centralized data sources, authentication services, and other back-office systems.
- Secure Print Release — ensures that documents are only printed when the user who printed them is present to pick up the jobs. Ensures that confidential information is protected and unwanted documents are automatically deleted.
- Color Control — empower your employees to responsibly use color printing by providing color print job cost information each time they print. Optionally limit color printing to specific user groups and applications making color cost-effective and available for business critical documents.

TARGET MARKET

The iMFP for Canon is targeted towards office and educational markets to meet the needs of employees, students, faculty, school districts, and libraries.



EQUITRAC EMBEDDED FOR CANON

OVERVIEW

Equitrac Embedded™ for Canon puts comprehensive matter-centric print tracking and cost recovery at your fingertips—in the control panel of your MEAP-enabled Canon imageRUNNER multifunction device.

With the fully integrated cost recovery platform, Equitrac Professional® 5, legal and other professional firms can speed and increase recovery of all client-billable expenses—not only digital copies, prints, and scans, but importable cost items such as research, couriers, postage, phone calls, catering, and other client-related disbursements. Along with Active billing system integration and Web-based exception editing, Equitrac Embedded for Canon help firms realize their full cost recovery potential.

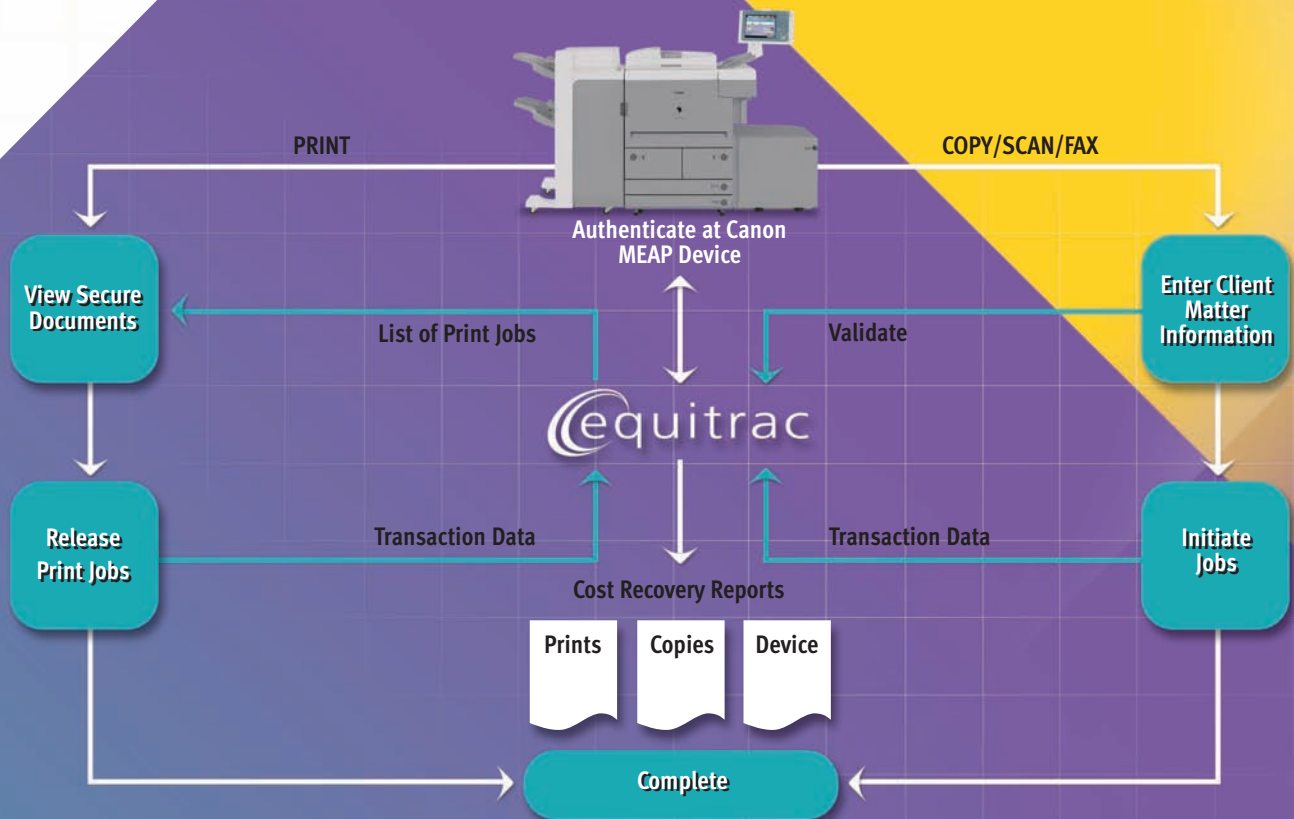



SOLUTION SCENARIO

A law firm was looking to increase its recovery of client-billable costs without learning all new systems or changing the way its attorneys and support staff work. With the Equitrac Embedded technology and the latest generation Equitrac Professional software, the firm implemented an easy-to-use solution accessible directly through the touch screens of their Canon imageRUNNER devices enabled by MEAP technology. Now users simply enter client and matter billing information before releasing print jobs, copying, scanning, or faxing. Only with Equitrac solutions can you assure that print jobs are output by authorized users. Transactional information on page count, output attributes, and finishing options is captured by Equitrac Professional for costing, reporting, and upload to the time and billing system. The solution has improved billing accuracy and increased cost recovery. Using Equitrac reports, the firm has made better printing decisions and gained new insight into profitability. Best of all, the solution delivered a return on investment in less than three months.

BENEFITS

- Application ties directly into the cost-recovery solution offered by Equitrac for pricing and reporting.
- No need for additional hardware.
- User-authentication provides tracking and security at the device.
- Reduce waste of misprints and unclaimed print jobs.
- Tracking of print jobs, including differentiation between color and black-and-white copies.

TARGET MARKET

Law firms, architecture, and engineering companies, consultants, and other professional services providers

SOLUTION COMPONENTS

- Equitrac Embedded for Canon
- Equitrac Professional 5
- Canon imageRUNNER device enabled with MEAP technology



Independent Software Vendor MEAP Applications

nQUEUE EMBEDDED BRAND: INTEGRATED COST RECOVERY FOR CANON

OVERVIEW

nQueue, a leading provider of cost-recovery solutions for the legal marketplace, has developed a software-based cost-recovery and control solution that resides directly on a MEAP imageRUNNER device. nQueue's popular Embedded brand now includes Integrated Cost Recovery for Canon—a user-friendly and feature-rich embedded application for Canon devices. As a software only solution that's installed on each Canon imageRUNNER device, there are no hardware terminals, cables, or legacy maintenance issues. This nQueue solution utilizes the powerful MEAP architecture and reliable Canon hardware as a platform to provide all the necessary features to control, capture, allocate, and charge back transactions such as copy and scan activity. imageRUNNER devices with nQueue's integrated solution are real-time networked to nQueue's SQL nQplatform server for data collection and flexible reporting choices.



- Enterprise Data Collection
- MSSQL Web-Based Architecture
- Reporting Services
- Custom Data Import and Export
- Accounting System Integration
- Web Services API Support
- Full, Near, or Real-Time User and Validation Support
- Web-Based Administration



Client's Accounting Server



COPY AND SCAN TRACKING
End-User Data Input and Validation Performed at the imageRUNNER Device Panel with nQueue Integrated Cost Recovery

- Other Disbursement Collection**
- Print
 - Phone
 - Fax
 - Mail
 - Research
 - Dictation
 - Third-Party Data



SOLUTION SCENARIO

Law firms and other professional service firms typically monitor all costs, such as photocopying, scanning, and printing, and allocate these costs to their customers' invoices. The challenge firms face is to make this process of requiring users to enter accurate billing information simple and straightforward. For many years these firms have been offered an external hardware solution that provides the capturing and reporting of this information; however, this solution was expensive to purchase and maintain.

A customer with the nQueue Integrated Cost-Recovery for Canon can simply walk right up to a device and enter in the required information for cost-recovery. For example, a paralegal would enter a user ID, password, client matter, and/or case matter directly onto the touch-screen of the MFP. Any copy, print, or scan jobs would be tracked against this account for billing to the appropriate client and case. Expenses that were once difficult to account for can now be tracked and billed.

▶ SOLUTION COMPONENTS

- nQPlatform Server
- Embedded brand device license for Canon
- Canon imageRUNNER device enabled with MEAP technology

BENEFITS

- **Software Economics** – a software-based Embedded Brand MEAP solution will always be more economical than buying additional hardware and paying equipment maintenance charges.
- **Software Integration** – nQueue Embedded Brand coupled with Canon's MEAP technology platform enables truly seamless integration with other applications, as well as extensive customizability.
- **Lower Total Cost of Ownership** – With external proprietary boxes eliminated from the cost recovery equation, companies will save money on not only the hardware, but also eliminate the need for proprietary wiring, and save staff time on installs and troubleshooting.
- **Fast Implementation** – Elimination of hardware and related configuration and wiring, streamlines the software-based MEAP integrated installation resulting in reduced implementation times.
- **Overall Reliability** – the integrated nQueue solution along with more mature software versions contributed to a significant increase in overall MFD functional reliability.

TARGET MARKET

nQueue embedded cost recovery solutions are targeted towards Professional Services, Legal, Accounting, Advertising, Engineering, Healthcare, Financial Services, and Facility Management Companies.



Canon Branded MEAP Applications

imageWARE DOCUMENT MANAGER CLIENT FOR MEAP

▷ OVERVIEW

imageWARE Document Manager Client for MEAP is the client software for imageWARE Document Manager. It allows users to send, index, and store scanned documents directly to, and in a specified destination on, the imageWARE Document Manager Server. It also forwards incoming faxes to Document Manager automatically.

imageWARE Document Manager Client for MEAP resides on MEAP-enabled imageRUNNER devices and all jobs are performed through the control panel on the device. Therefore, it gives users a flexible and easy-to-use tool to import data and images from imageRUNNER MEAP devices to imageWARE Document Manager for an efficient digital workflow.

imageWARE™

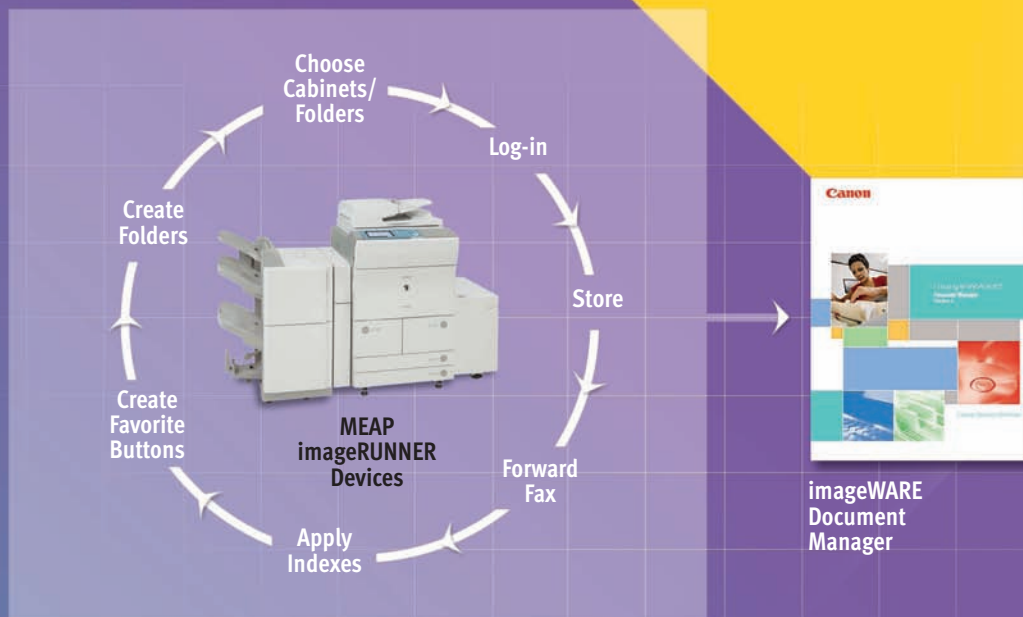

SOLUTION SCENARIO

A national financial services provider has branch offices across several states. The company deploys imageWARE Document Manager in its central office to manage credit card applications along with other financial documents. In imageWARE Document Manager, a folder is created as “New Credit Card Application.” “Form Number,” “Applicant Name,” “State,” and “Date” are set up as user indexes.

Each branch office has one MEAP-enabled imageRUNNER 5570 device. imageWARE Document Manager Client for MEAP is installed on each imageRUNNER device to expedite the credit card application process. Twice a day, the office clerk puts all new applications on the imageRUNNER device. Through imageWARE Document Manager Client for MEAP, the clerks scan the applications as TIFF files, key-in the index value for each index field, and send to the “New Credit Card Application” folder.

The new applications can be processed immediately at the central office. The electronic approval process can be done in a day, instead of several days as compared to the traditional method.

SOLUTION COMPONENTS

Minimum Requirements for imageRUNNER Devices:

- Hard Disk: 100MB
- Memory: 5MB

Service Provider Host Computer Minimum Requirements:

- CPU: 500MHz Intel Pentium II
- RAM Capacity: 128MB
- Hard Disk Capacity: 100MB
- XP Professional SP1/1a/2
- 2003 Server with SP1

Operating Systems:

- Windows 2000 Professional with SP3/4
- 2000 Server with SP3/4
- 2000 Advanced Server with SP3/4

Required Software:

- .Net Framework 1.1
- Internet Information Service (IIS) 5.0 or Later
- imageWARE Document Manager Client v4.0
- imageWARE Document Manager v4.0

BENEFITS

- Easy-to-use tool to import data and images from MEAP-enabled imageRUNNER devices to imageWARE Document Manager.
- Provides a seamlessly integrated Canon solution for integrating paper documents into digital workflow.
- Streamlines the hard-copy conversion workflow to increase efficiency and productivity.
- Provides push-scan functionality to give more flexibility at the user level.
- Supports ad hoc document capture and management capabilities.
- Creates a paperless environment for sensitive information through automatic fax forwarding.
- Allows high-quality color scanning through compatible Color imageRUNNER devices.

TARGET MARKET

imageWARE Document Manager Client for MEAP is designed for customers who are looking for an easy-to-use tool to streamline hard-copy conversion workflow. It's ideal for customers who need to import data and images from MEAP-enabled imageRUNNER devices to imageWARE Document Manager directly for an effective and complete digital workflow. It increases the value of a customer's investment by enabling seamless integration of Canon imageRUNNER devices and imageWARE Document Manager.

SOLUTION SCENARIO

A large corporation wanted to deploy Color imageRUNNER devices, but was fearful of abusive color usage, which will lead to increased document output cost. It installed imageWARE Accounting Manager for MEAP on all Color imageRUNNER devices and monitored the usage for one month. It was able to clearly determine “who” was printing “what” “where,” and “when”. They were able to obtain a clear breakdown of color and black-and-white usage by individual users. All users were informed about responsible usage of color devices and also utilizing duplex or N-up features of the device. Next month it was discovered that most of the color jobs were business-related and some employees have started utilizing duplex and N-up features of the device.

This solution works directly on the device, eliminating the need for a dedicated server PC and, thus, reducing IT overhead cost.

BENEFITS

- Schedule automated reports provides thorough document output analysis that enable you to make quick, cost-saving decisions
- No IT overhead—Software is installed and runs on the MEAP enabled imageRUNNER device. No dedicated server or IT Administrator required
- Determine how and when to use color in your business for maximum impact at minimum cost
- Easy management of multiple Canon imageRUNNER devices by Data Collecting Application
- Setup usage limits (Copy/Print/Scan) using Department ID upload feature

SOLUTION COMPONENTS

MEAP enabled imageRUNNER device

Workstations used to browse imageWARE Accounting Manager for MEAP

Operating Environment

- Pentium® III MHz or higher
- 100MB or more free hard disk space
- 128MB or more RAM

Web Browser

- Microsoft Internet Explorer 5.5 with Service Pack 2
- Microsoft Internet Explorer 6.0 with Service Pack 1 or Service Pack 2

Data Collection Application

Operating Environment

- Pentium III MHz or higher
- 100MB or more free hard disk space
- 128MB or more RAM

Operating System

- Microsoft Windows 2000 Professional/Server with Service Pack 2
- Microsoft Windows XP Professional with Service Pack 2
- Microsoft Windows Server 2003 Standard Edition with Service Pack 1

TARGET MARKET

imageWARE Accounting Manager for MEAP is targeted towards every imageRUNNER and Color imageRUNNER customer who wants to reduce excessive color output and control document output cost.



Canon Branded MEAP Applications

VIRTUAL MAILBOX

OVERVIEW

Most people today preprint the documents they need prior to a business trip or put them on a laptop, then print them at the destination. With Canon Virtual Mailbox (VMB), there's no need to preprint documents or carry a laptop—you can print from anywhere within your corporate intranet. Canon VMB allows an organization to manage its mobile printing requirements. Users load their most frequently used documents to their Mail Box and access it from VMB within the enterprise when they're ready to print.

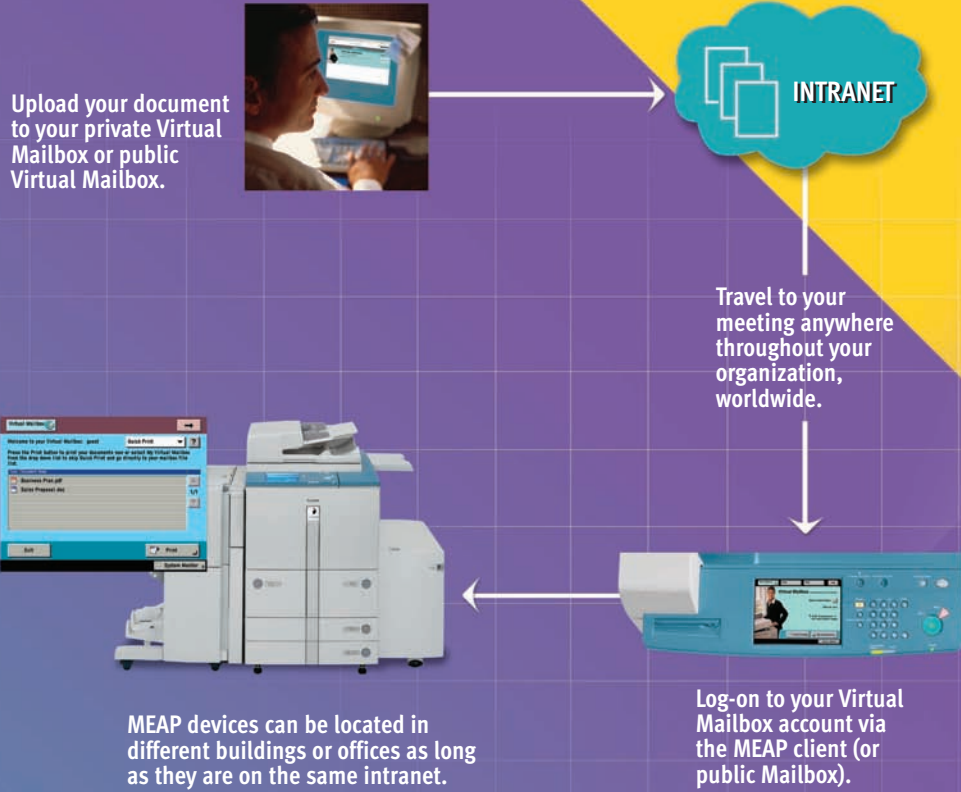

SOLUTION SCENARIO

CONTROL WHERE YOU CAN PRINT

- Have you ever walked to another building for a meeting and realized that you forgot your documents? With VMB, you can simply walk up to a MEAP-enabled device and print your document.

DISTRIBUTE STANDARD CORPORATE DOCUMENTS

- Would you like to reduce the postage costs your company incurs by mailing out the same standard company documents (i.e., HR Forms, time-out sheets) to every single employee? With VMB, place these documents in a public folder and then let every employee access them when needed.

CONTROL CONFIDENTIAL PRINTING

- VMB solution allows you to control confidential printing dynamically. Not only do you get to select when you're going to print, but also where you're going to print.

SOLUTION COMPONENTS

- Canon Print Server Appliance (PSA) is required
- One imageRUNNER device with MEAP capabilities is required
- Number of Mail Boxes: 10, 20, or 50
- Storage per Mail Box: Configurable by VMB System Administrator/IT Manager
- Number of MEAP Clients Supported: No Limit
- Maximum Number of Public Mail Boxes: 25
- Multi-VMB Server Support: Yes, across the same intranet
- Import LDAP Users for Setup Ease: Yes, from Active Directory
- Installation Process: Web-based; all components can be downloaded from Canon Services Portal
- Client Driver OS Supported: Microsoft Windows 98/2000/XP, Windows NT
- Single Client Driver Available: One Print Client for all supported devices

Note: The VMB application requires a Canon Print Server Appliance and at least one imageRUNNER device with MEAP capabilities.

BENEFITS

- **Anywhere Printing:** You can access your documents anywhere throughout the company using an imageRUNNER device enabled with MEAP capabilities.
- **Driver-Less Printing:** There's no need to go through the confusing process of installing printer drivers for every device to which you want to print.
- **Confidential Printing:** Since print jobs are not printed until you log-in, your documents remain confidential.
- **Easy Repeat Printing:** Frequently used documents, such as presentations or forms, can be printed easily and without having to access your computer.
- **Easy to Install and Administer:** Since this scalable robust printing solution is built on the MEAP and PSA platforms, installation and administration is a snap.

TARGET MARKET

Virtual Mailbox enables mobile printing for any organization.



Summary

MEAP technology reaffirms Canon's strength in integrated solutions, enabling MFP devices to function not just in document processing silos, but also as part of an integrated enterprise solution involving computing, networking, storage, and communication devices. MEAP provides the first opportunity to integrate hard-copy operations directly into the workflow of enterprise software applications, such as reporting, administration, document management, ERP, accounting, HR, and customer management. The benefits of integration can mean only one thing for an organization—simplicity and higher productivity. We encourage you to visit our Alliances section of the Canon U.S.A., Inc. Web site at www.usa.canon.com to get up to date information on the latest MEAP releases and new development partners. You should check the Canon site frequently since development is always an ongoing activity, and learn about Canon's commitment to providing robust workflow solutions for today's unique business environments.

Canon U.S.A. publishes these guides as some of the products and services may be helpful to you or may be compatible with your Canon products. Canon U.S.A. does not warrant or guarantee the included third-party solutions in any way. Canon U.S.A. has no responsibility for your use of the third-party products and solutions, or their compatibility with Canon products in any way.

Index

TYPES OF MEAP APPLICATIONS

APPLICATION NAME	PAGES	Custom MEAP Applications	Independent Software Vendors MEAP Applications	Canon Branded MEAP Applications
Advanced Authentication	6	■		
Authorized Send	2	■		
Captaris RightFax Integration for MEAP	14		■	
Codehost: imageRUNNER Smart Card Authentication	16		■	
eCopy ShareScan OP	10		■	
Equitrac Embedded for Canon MEAP	20		■	
GBCblue—COPYblue	8	■		
imageWARE Accounting Manager for MEAP	26			■
imageWARE Document Manager Client for MEAP	24			■
nQueue Embedded Brand: Integrated Cost Recovery for Canon	22		■	
Pharos iMFP for Canon	18		■	
Ribstone EM1	12		■	
Scan-to-Database	4	■		
Virtual Mailbox	28			■





Active Directory is a registered trademark or trademark of Microsoft Corporation in the United States and/or other countries. Captaris RightFax is a trademark of Captaris. Equitrac is a registered trademark of Equitrac Corporation. Pharos, Off-The-Glass, and Uniprint are registered trademarks of Pharos Systems International. Codehost is a registered trademark of Codehost, Inc. NQUEUE is a registered trademark of nQueue, Inc. Ribstone is a registered trademark of Ribstone Systems, Inc. Microsoft and Windows are registered trademarks of Microsoft Corporation in the United States and/or other countries. eCopy and eCopy ShareScan OP are trademarks of eCopy, Inc. Novell is a registered trademark of Novell, Inc. in the United States and other countries. Celeron, Intel, and Pentium are trademarks or registered trademarks of Intel Corporation or its subsidiaries in the United States and/or other countries. VISA is a registered trademark of Visa in the United States and other countries. MASTERCARD is a registered trademark of MasterCard. AMERICAN EXPRESS is a trademark of American Express Company, its subsidiaries and affiliates. DISCOVER is a trademark of NOVUS Credit Services Inc. or their respective third-party owners. CANON, IMAGERUNNER, and MEAP are registered trademarks of Canon Inc. in the United States and may also be registered trademarks or trademarks in other countries. IMAGEWARE is a registered trademark of Canon U.S.A., Inc. in the United States and is a trademark of Canon Inc. in certain other countries. IMAGEANYWARE is a trademark of Canon. All referenced product names and other marks are trademarks of their respective owners.

Specifications and availability subject to change without notice.
©2006 Canon U.S.A., Inc. All rights reserved.

1-800-OK-CANON
www.usa.canon.com

Canon U.S.A., Inc.
One Canon Plaza
Lake Success, NY 11042